

# Nano-bubble Hydrogen SPA Machine User Guide

- ※ Before using, make sure you study this user guide thoroughly.
- ※ Please note that you will be required to pay the service charge unless you follow the precautions set forth by us.

## Key Specifications

**Bubble size:** 90nm~99nm on average / **Bubble quantity:** Approx. 500 million bubbles per 1ml (This machine captures hydrogen gas in nano-bubbles.)

## Machine Specifications

**Name:** Nano-bubble Hydrogen SPA Machine / **Model Name:** HM-SPA500 / **Power:** 100V~240V, 50Hz~60Hz / **Size:** 50 x 41 x 100cm

**For the inquiries of repairs and consumables, please contact the authorized agent in your territory. Headquarters' contact detail:** cs@huelight.kr

Please note that in case that the product is taken apart by at your discretion, you're not eligible to be free-serviced including force majeure, damage and breakdown caused by users' negligence.



## Components

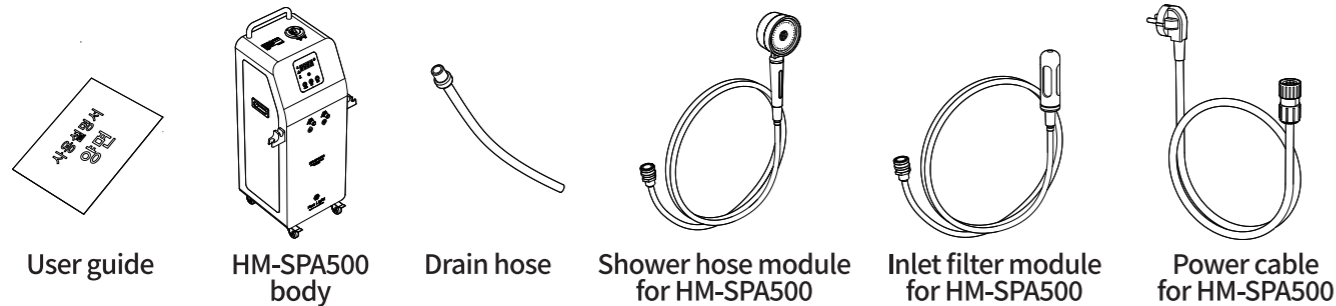

## Before you start

- ※ The hydrogen gas generated by this machine is captured in nano-bubbles less than 100nm and sprinkled with water using special principles and technology. Therefore, there is no risk of explosion, but due to the nature of hydrogen gas, do not use lighters, matches, cigarettes, etc. near the inside the machine, nano-bubble outlet, or the extracted nano-bubble water.
- ※ Keep out of flames and set-on-fire environment, in case the product is used.
- ※ Do not block the outlet and inlet of this machine, and do not reverse the outlet and inlet. Incorrect use may affect the product life.
- ※ This machine is equipped with a water flushing function using hydrogen to flush out residues inside for hygiene immediately after use. An abrupt sound may cause you uncomfortable when the gas is out with the water towards the shower after the end of use, but please rest assured that this is one of the operative procedures.

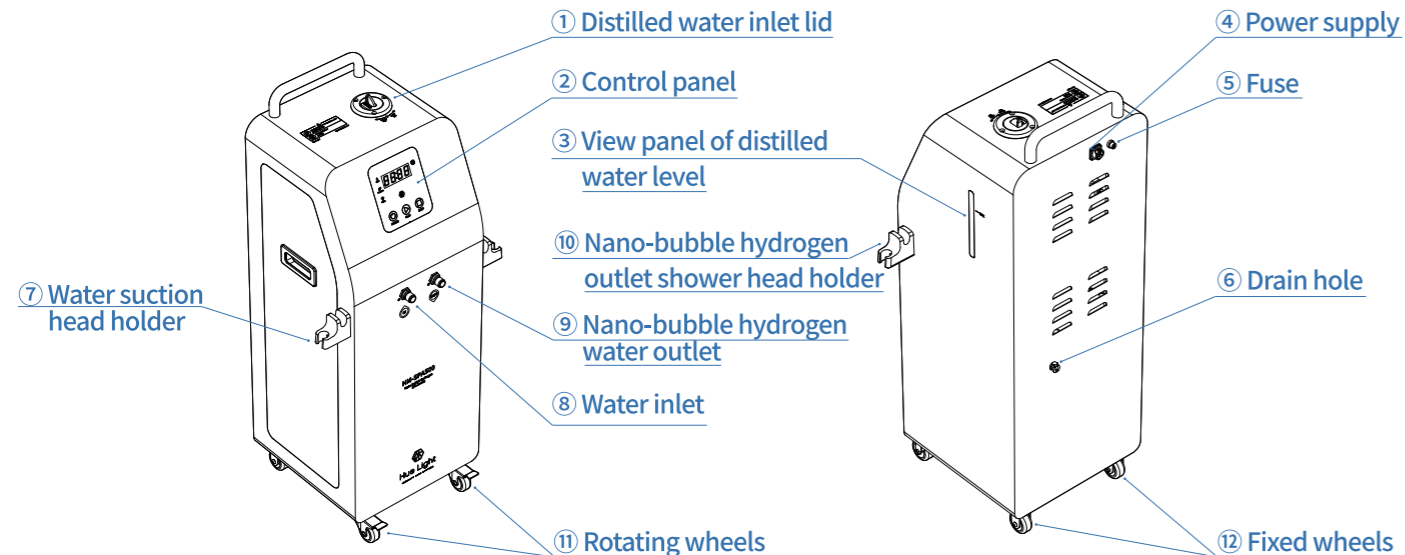

## Precautions

### 1 Distilled water inlet lid

When filling sterile distilled water, remove the lid. Make sure the lid is completely closed when in use. Only sterile distilled water should be used to generate hydrogen gas for this machine. Also, for hygiene purposes, close the distilled water inlet lid thoroughly after injecting distilled water.

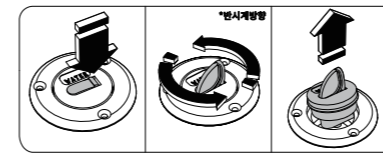

[How to open the water inlet]

### 2 Control button panel

The control panel is capacitive touch sensitive. If you are wearing gloves and pressing it, it may not recognize your touch properly. Also, in case water is smeared, it may cause a temporary malfunction. In this case, please wipe the water off before use.

### 3 View panel of distilled water level

In case that you want to know how much the water level is indicated, the distilled water level view panel allows you to check the amount of sterile distilled water inside the machine. Regardless of water level, it does not affect the amount of gas generated. It is recommended to replenish 1 liter of distilled water in refilling.

### 4 Power supply

Due to the characteristics of the machine, it is equipped with the exclusive waterproof push-lock typed power supply for the sake of users' safety. However, since be aware that this is an electronic device, Make sure to avoid water contact by any account. Please also make sure that the power supply be slotted into the outlet firmly.

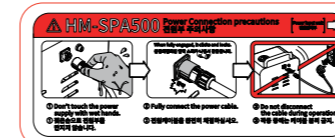

※ The warning for the power supply is attached right next to the power supply inlet.

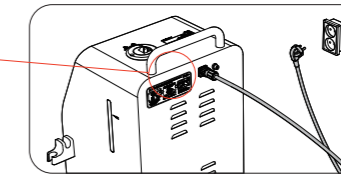

※ Please note that the exclusive push-lock typed supply cord would not be taken apart when pulled. When the device tips over or is dislodged by force, the power cord is taken apart whereby the power is cut off safely.

### 5 Fuse

The fuse is installed to protect the machine and users in the event of sudden voltage fluctuation and short circuits. Since the quality of electricity varies in accordance with local conditions and may cause troubles, the fuse may be disconnected. In case of that the power shuts off, please refer to the instructions shown below when replacing the fuse.

- ※ After replacing the fuse, be sure to close the cover.
- ※ Be sure to remove the blown fuse.
- ※ Fuse specifications:  $\phi 5 \times 20\text{mm}$  10A

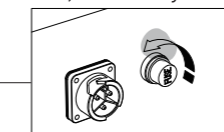

[Removal of the fuse cover]

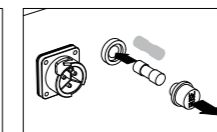

[Replacement of the fuse]

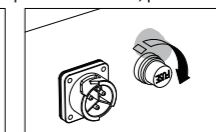

[Assembly of the fuse cover]

### 6 Drain hole

When draining, follow the instructions on the right side of the drain. Do not drain while the machine is operative. If you refill the water tank just after draining, make sure that the drain hose is firmly closed.

### 7 Water suction head holder

The water suction head is hung on the side holder. Please refer to the figure shown below.

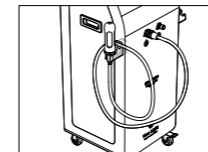

### 8 Water inlet

Be sure to connect the inlet filter module for HM-SPA500 before use. Some water may dribble when the hose is taken apart after use.

### 9 Nano-bubble hydrogen water outlet

Please connect the shower hose module for HM-SPA500 before use. Some water may dribble when the hose is taken apart after use.

How to connect the water inlet to nano-bubble hydrogen water inlet

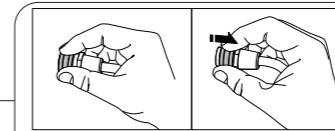

① Grip and pull outward the end of the connecting part (quick coupling).

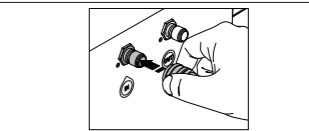

② While pulling the end of the connecting part (quick coupling), push the plug to the end.

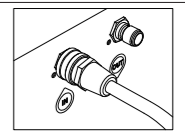

③ Make sure to see if it's firmly locked.

### 10 Nano-bubble hydrogen outlet shower head holder

For users' convenience, the machine is equipped with a shower head holder on the side of the machine. Please refer to the figure shown below.

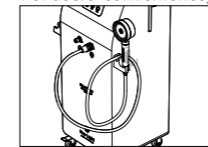

### 11 Rotating wheels

There are two rotating wheels on the bottom for rolling smoothly. After locating the machine, please have the wheels latched to keep it from being on the go before use.

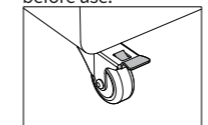

[Wheels when rolling]

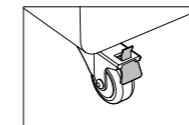

[Wheels latched]

### 12 Fixed wheels

There are two fixed wheels on the bottom. These wheels roll the direction they are latched.

## 1. A pre-step for use

- 1 Connect the HM-SPA500 inlet filter module to the main body.
- 2 Connect the shower hose module for HM-SPA500 to the main body.
- 3 Connect the HM-SPA500 power plug to the main body.
- 4 Connect the main power plug to an outlet.

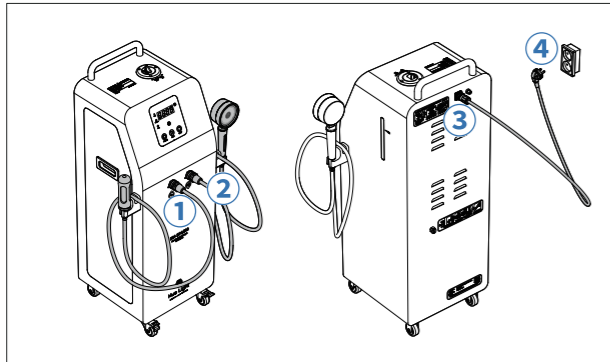

## 2. How to pour distilled water to the main body

- 1 Check the water level beforehand.
- 2 Twist to open the distilled water inlet lid by turning it counterclockwise.
- 3 Slowly pour distilled water to the distilled water inlet.
- 4 Close the distilled water inlet lid clockwise.

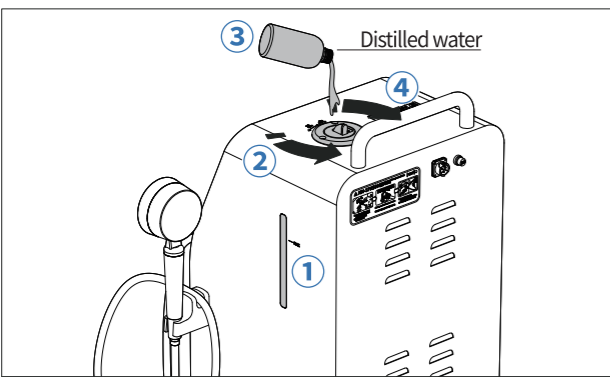

## 3. Placing the hose into a bathtub or water container

⚠ Never use bath bombs, soaps, bubbles, or other additives in the bathtub.

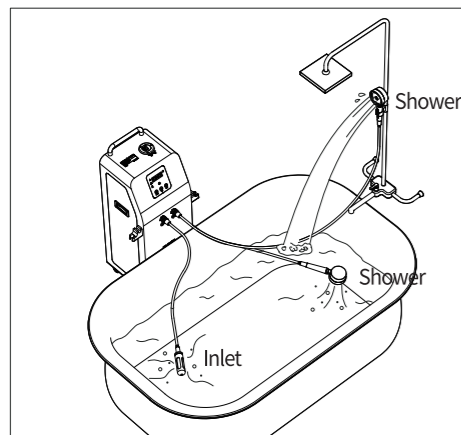

- 1 Make sure that the water level in the bathtub is sufficient. (Make sure to have the exclusive HM-SPA500 inlet filter module submerged in water.)
- 2 Double check if the exclusive HM-SPA500 inlet filter module is properly submerged in water. (If you run the machine without water, it may cause machine failure.)
- 3 Place HM-SPA500 dedicated shower hose module in a suitable location. (Place the module toward the bathtub, NEVER make the shower directed towards the machine.)

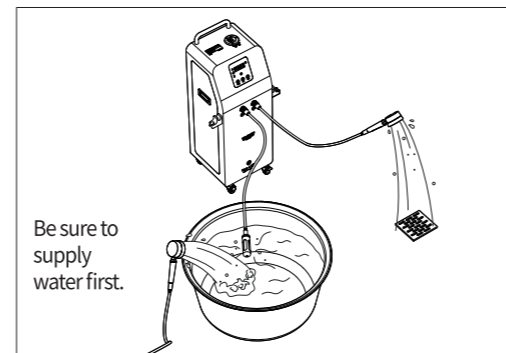

※ In case resume the usage after the machine not in used for long time, make sure to proceed with a warm-up for up to 3 minutes for the sake of a proper water circulation inside.

## 4. How to use

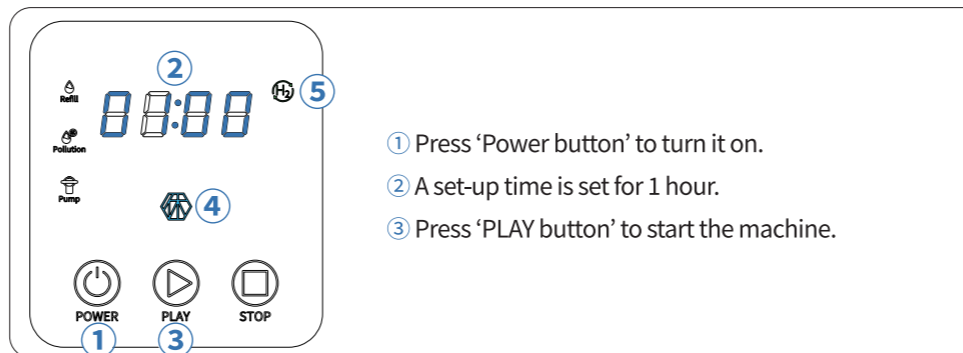
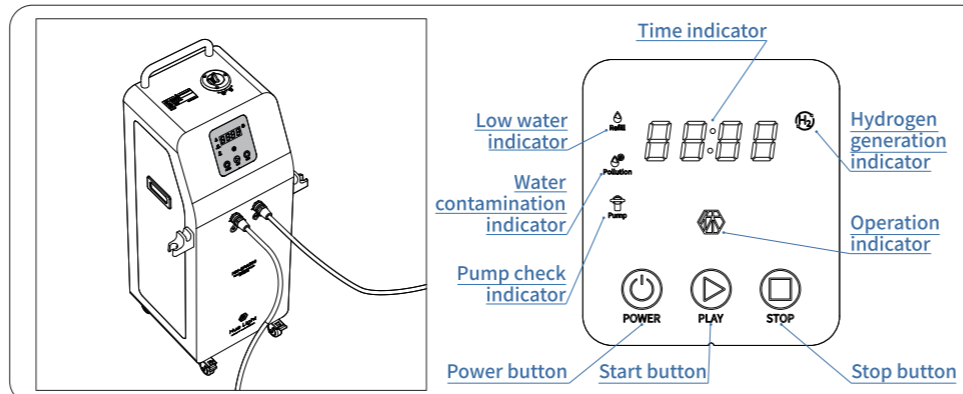

- 1 Press 'Power button' to turn it on.
- 2 A set-up time is set for 1 hour.
- 3 Press 'PLAY button' to start the machine.

※ When the machine starts, a bluish Hue Light logo light 4 is on. The hydrogen generation indicator light 5 is on after the operation is confirmed in one minutes. A green light indicates that the machine is normally operative.

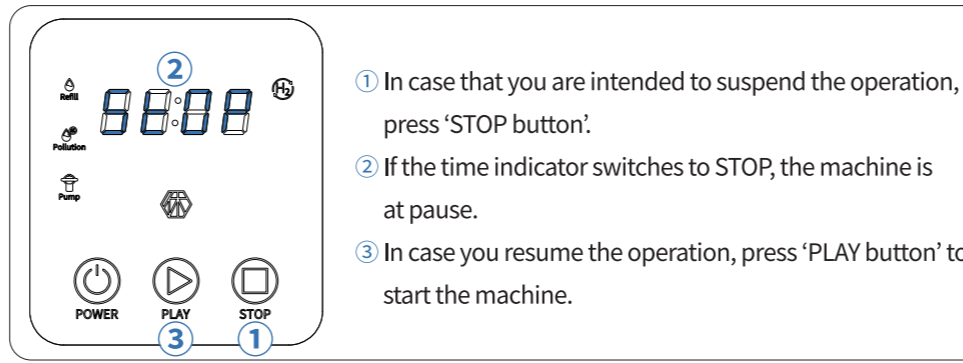

- 1 In case that you are intended to suspend the operation, press 'STOP button'.
- 2 If the time indicator switches to STOP, the machine is at pause.
- 3 In case you resume the operation, press 'PLAY button' to start the machine.

## 5. When the machine halts while in use (In general)

※ Check if the set time is up.

### 1 Insufficient distilled water

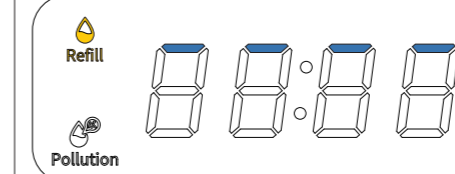

※ Make sure to check if the distilled water is sufficient or not. If in case that the indicator is shown adjacent to the diagram, make sure to replenish the distilled water. (It is recommended to pour 1 liter of distilled water at a time.) As for the replenishment, please refer to [2. How to pour distilled water to the main body].

※ The low water indicator is connected to a sensor that continuously checks the water level. When the distilled water is refilled, the low water indicator will disappear.

### 2 Water contamination

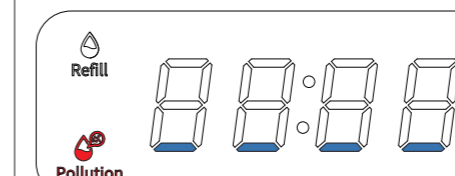

※ Make sure to check if distilled water for the main body is contaminated or not. If in case that the indicator is as shown in the figure, the water inside must be removed and refilled. As for drainage, refer to the [Drainage instructions sticker] attached next to the drainage outlet on the main body.

※ The water contamination indicator is connected to a sensor that continuously checks for contamination. Replace the distilled water. (Make sure to refill the new distilled water after removal.)

### 3 Tilted

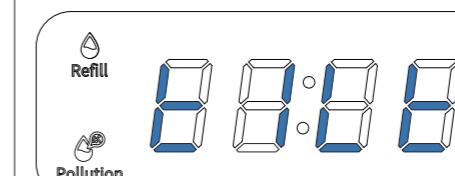

※ For users' safety, all the functions shut down when tilted. When happens, 'tilt' is indicated on the panel. After the machine is upright position, press 'PLAY button' to resume.

⚠ Please don't be panic when the contamination indicator is on the panel as the sensor measures an temporary value. The water contamination indicator is a measure to protect the polymer electrolyzer inside the machine. Therefore, the illumination of the water contamination indicator on the panel does not mean that contaminated gas is coming out of the discharge port. In this case, make sure to drain the water immediately and replace it with fresh distilled water. The damage of PEM electrolyzer may vary depending upon the extent of a contamination and the exposure time to contamination. Hence, make sure to use sterile distilled water only.

▶ **PLAY** ※ In a case where the machine is paused due to any problem and when the problem is solved, the machine will not restart automatically. The user must press the 'PLAY button' to continue using the machine.  
[The machine starts again from the time when the machine stopped with the time being previously set.]

## 6. When the machine halts while in use (What to check)

※ **Before use, wash your body with a soap or detergent and fill the bathtub with clean water.** Do not attempt to add soap bubbles, aromas, or bath bombs to the bathtub. Soap bubbles or additives in the bathtub may cause the glitch of the machine.

※ This machine detects the operation of the water circulation pump for safety purposes. If the pump suspends, or if the pressure inside the pump is over-pressured, the machine will stop. In this case, the panel will be as shown in the figure. Please check the followings.

- 1 Check if the water inlet is clogged by foreign objects or if the suction is unabled.
- 2 Check if the hose of the nano-bubble hydrogen water outlet is folded or clogged. **-Please use the shower without an on/off switch.** So make sure to take a precaution as the device generating nanobubbles inside may be damaged.
- 3 **Do not use the shower with a filter or the on/off function.**

The pressure of the pump and other elements have been meticulously designed to generate nanobubbles. When a foreign filter is used, it will lead to the change of the pressure value, resulting in the glitch of the device.

In case other problems are not found after the checklist is reviewed, resume the turn-on after a turn-off for a while. If the condition still remains as shown in the figure, please contact us immediately for the inspection.

<Please contact your local distributor or our headquarters email: cs@huelight.kr>